

DOOR PANEL INSTRUCTIONS

CUSTOM OVERLAY PANEL INSTRUCTIONS FOR MODEL DRC033

To make a drop in door panel that covers the door and the front of its aluminum edge, add the KHAND to cover the top edge and a cabinet pull that matches the pulls on surrounding cabinets to better blend in with the existing cabinetry.

Cut the filler panel to the dimensions shown. Apply the edge detail to the bottom, left and right sides.

The following directions are for a 3/4" x 15" w x 29"h panel door blank:

- 1 From the back side of the door cut a 1/16" w x 11/32" h rabbet on both sides and the bottom edge of the panel.
- 2 Set the saw blade to 1/4" height and cut groove in the edge of the door 7/32" from the back of the door.
- 3 On the hinge side of the door cut a 45-degree chamfer on the top with either a saw or a router.

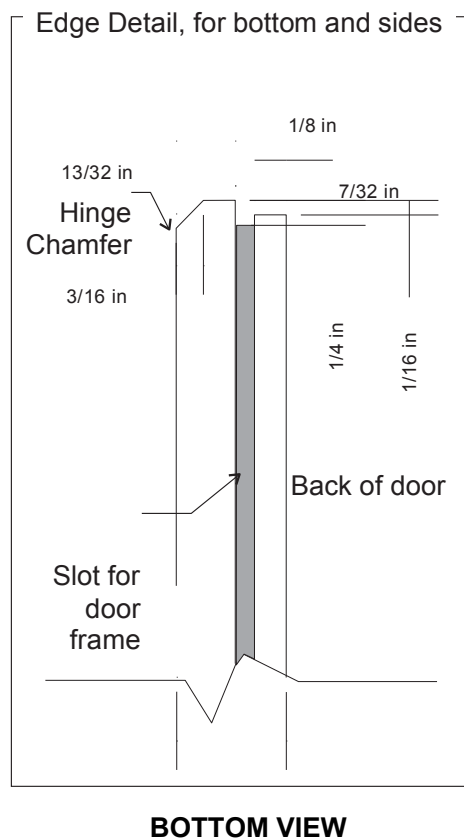
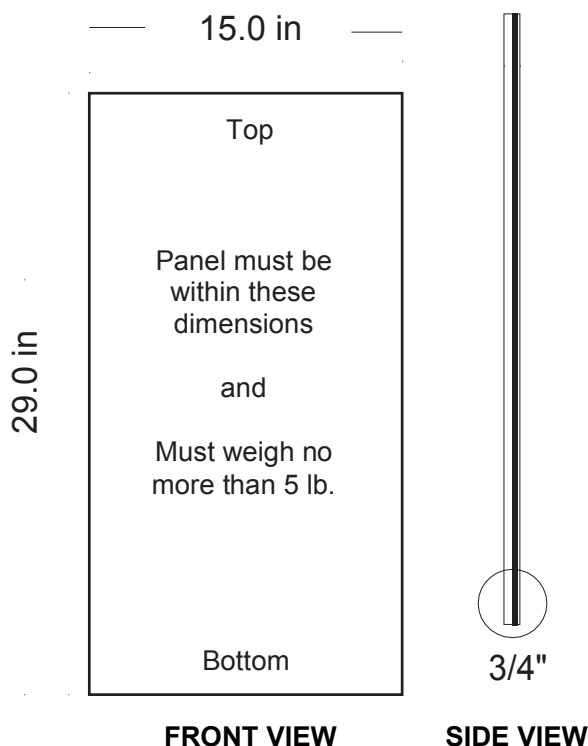

DOOR PANEL INSTRUCTIONS

KDFR KIT

Instructions for reusing an existing wood overlay door panel from a DCE33/DRC035 onto a Brilliance model. Our ice machines are supplied without a conventional door covering which can also be decorated also to the user's preference. These options include being able to reuse an overlay door panel from a prior DCE/DRC model.

Retro-fit Door Kit Includes:

- Framed panel assembly
- Extra door handle for panels without knob
- Machine screws

Door Panel Assembly:

- 1 Remove the door handle/cover from the top of the framed assembly. **Do NOT take frame apart.**
- 2 Remove door panel from prior unit's door.
- 3 Slide recycled door panel into channels in door frame assembly.
- 4 Re-attach handle/top cover plate. Use handle type if no knob is on door panel.

To attach to the ice machine door:

Note: If door swing is to be changed, it must be done before panel is attached.

The panel will be held on by 8 machine screws.

- 1 Remove the gasket and retain for later use.
- 2 Place the framed panel assembly onto the outside of the door and secure it to the door using two machine screws, located at the left center and right center. Keep screws loose until all screws are used and then tighten all.
- 3 Fasten the panel to the door using the kit's screws. In the hinge areas, use the outermost (top and bottom) screw holes; leave the other hole open.
- 4 Place the covers over the hinge areas, and secure each cover to the door using a kit screw. Do not use screws from the hardware packed with the unit.
- 5 Insert hole plug over screw installed in previous step.
- 6 Return the gasket to its original position.

DOOR PANEL INSTRUCTIONS

DIAGRAM FOR REUSING AN EXISTING DOOR PANEL FROM DCE33/DRC033 ON A BRILLIANCE MODEL

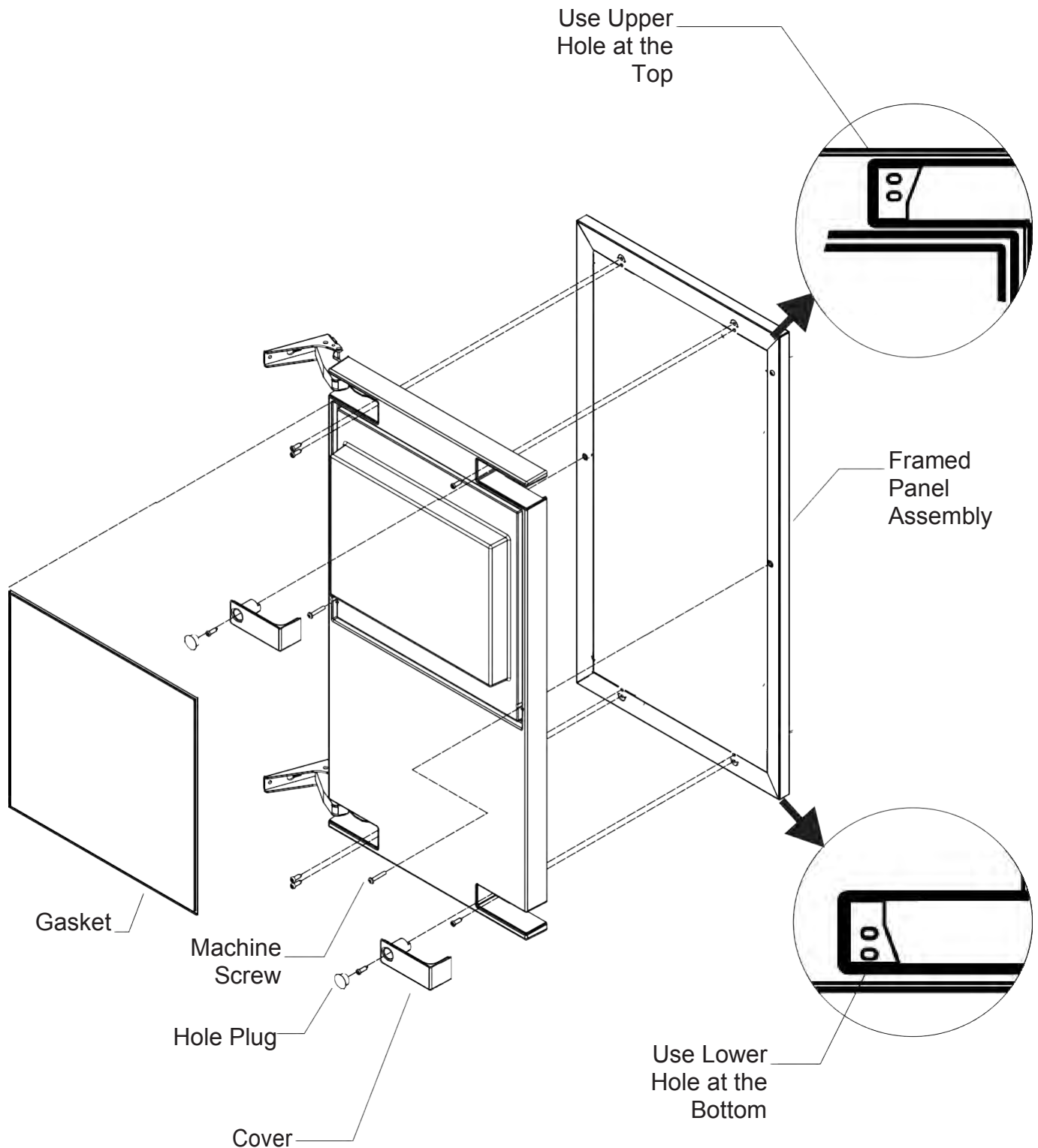

KSS INSTRUCTIONS FOR MODEL DRC033

For the Change to a Stainless-Steel, Wrap-Around Door

- ❶ Remove the original door: Open the door and remove the three screws holding the lower hinge to the cabinet.
Note: Save all screws for re-use.
- ❷ With the door open enough to see both screws at the top door hinge, remove the two screws.
The door is now free of the cabinet.
- ❸ Remove both hinges from the door and cabinet.
- ❹ Remove the door handle from the top of the door.
- ❺ Remove filler plate from the top of the door.
- ❻ Attach new door handle to the stainless-steel wrapper using the two pan-head screws from the kit.
- ❼ Place cardboard from kit onto channels of original door.
- ❽ Slip the door wrapper over the original door. Be sure it is seated firmly and covers the old door completely.
- ❾ Attach the new top hinge to the cabinet (use the original screws).
- ❿ Attach the new bottom hinge to the door (use the original screws).
- ⓫ Secure the door to the cabinet, bottom hinge first.
- ⓬ Insert machine screws from the kit into top of door where hinge is not attached.

